

The versions – thread inserts for expansion anchoring **SPREDSERT®** with retaining flange



**The advantages**

- For thermoset and thermoplastic components
  - High-strength threads in through holes
  - Screw locking
- Material: Cu Zn 38 Pb 2 (EU 2000/53 compliant)

**Principle**

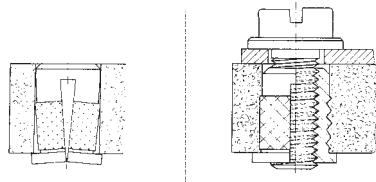

The **SPREDSERT®** with retaining flange is inserted into the through hole until the retaining flange is seated. The slotted anchoring section with diamond knurl is compressed.

By screwing in the screw, the thread insert is forced open in the anchoring section so that the diamond knurling penetrates the plastic material. The retaining flange which acts as a shoulder support ensures high pull-out locking while the screw is also locked. For the additional expansion force, the tightening torque must be increased by 10 %.

**Technical data**

Type 0835

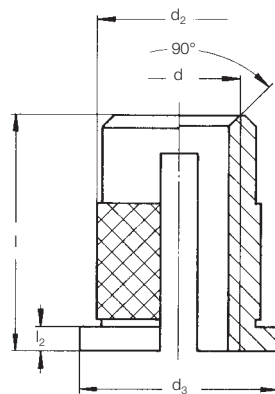

Mounting hole<sup>①</sup>

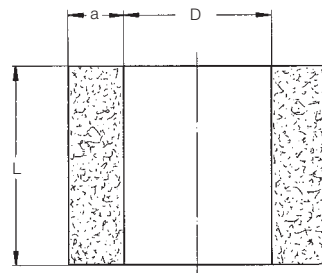

For installation tools and machines, see pages 39 – 40

d	Order No	l <sup>①</sup>	d <sub>2</sub>	d <sub>3</sub>	l <sub>2</sub>	D <sup>+0.1①</sup>	L <sub>min.</sub>	a <sub>min.</sub>
M 3	0835 103 0048	4.8	4.3	5.5	0.5	3.9	4.5	3.2
M 3.5	0835 135 0064	6.4	5.1	6.3	0.7	4.7	6.0	3.6
M 4	0835 104 0008	8.0	6.0	7.0	0.8	5.5	7.5	4.0
M 5	0835 105 0095	9.5	6.8	8.0	1.0	6.3	9.0	4.8
M 6	0835 106 0127	12.7	8.4	9.5	1.3	7.9	12.0	6.0
M 8	0835 108 0127	12.7	9.9	11.0	1.3	9.4	12.0	7.1

Metric ISO thread according to DIN 13-6H.  
Technical modifications reserved.  
Minimum quantity on request.  
All dimensions in mm.

① Guide values: depend on moulding material, may have to be changed after setting trials.  
② Screw contact length = min. insert length (l) + 1p (pitch)

Other sizes and special designs on request.