

The versions – thread inserts for self-forming insertion **QUICKSERT® plus**



The advantages

- Suitable for thermoplastic parts
- High-strength and torsion-proof threads
- Chipless installation
- Special version available with external left-hand thread for improved reverse locking
- Material: Cu Zn 38 Pb 2 (EU 2000/53 compliant)

Principle

QUICKSERT® plus consists of a tapered basic body (8° overall taper) with internal thread, additional internal hexagon and a special external thread.

The profile of the external thread has an extremely small flank angle and expands asymmetrically towards the thread root. Driving torques for installation are thus reduced. Very good tight-fit is achieved with an ideal distribution of load. Since no cutting slot is required, there is no chip formation because the thread insert forms into the plastic material.

For special requirements, we offer a version with flange.

The threaded bush is inserted and screwed in with a rotating spindle.

Technical data

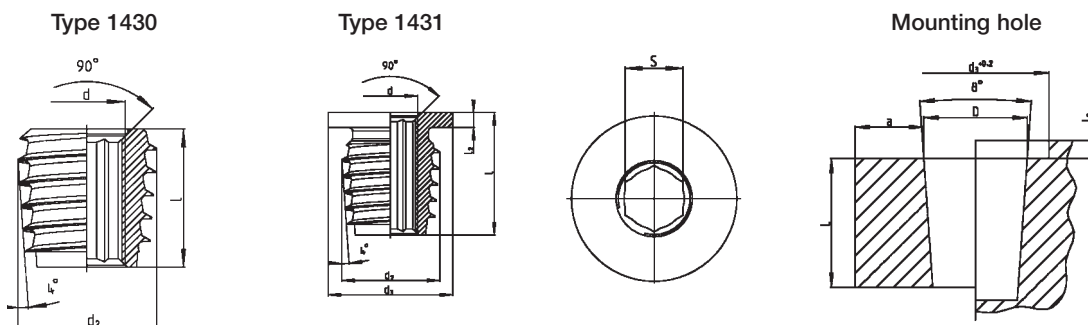

d	Brass Order No	D ^{+0.1} ⓐ	l	d ₂	L _{min.} ⓑ	a _{min.} ⓐ	S
M 4	1430 004 0008	7.10	8.00	7.74	8.00	5.00	3.20
M 5	1430 005 0009	8.20	9.00	9.15	9.00	5.50	4.00
M 6	1430 006 0011	9.50	11.00	10.70	11.00	6.00	5.00
M 8	1430 008 0014	11.90	14.00	13.69	14.00	7.05	6.50

d	Brass, with flange Order No	D ^{+0.1} ⓐ	l	l ₂	d ₂	d ₃	L _{min.} ⓑ	a _{min.} ⓐ	S
M 4	1431 004 0104	7.20	10.40	1.4	7.68	10.00	9.00	5.00	3.20
M 5	1431 005 0114	8.30	11.40	1.4	9.12	11.50	10.40	5.50	4.00
M 6	1431 006 0134	9.60	13.40	1.4	10.67	13.00	12.00	6.00	5.00
M 8	1431 008 0174	12.20	17.40	1.4	13.76	18.00	16.00	7.00	6.50

ⓐ Guide value – depends on moulding material, may have to be changed after setting trials.

ⓑ For blind hole L + 1 mm.

All dimensions in mm.

The versions – thread inserts for self-tapping insertion **QUICKSERT® plus**

Technical data

Driving torque values **QUICKSERT® plus M 5**

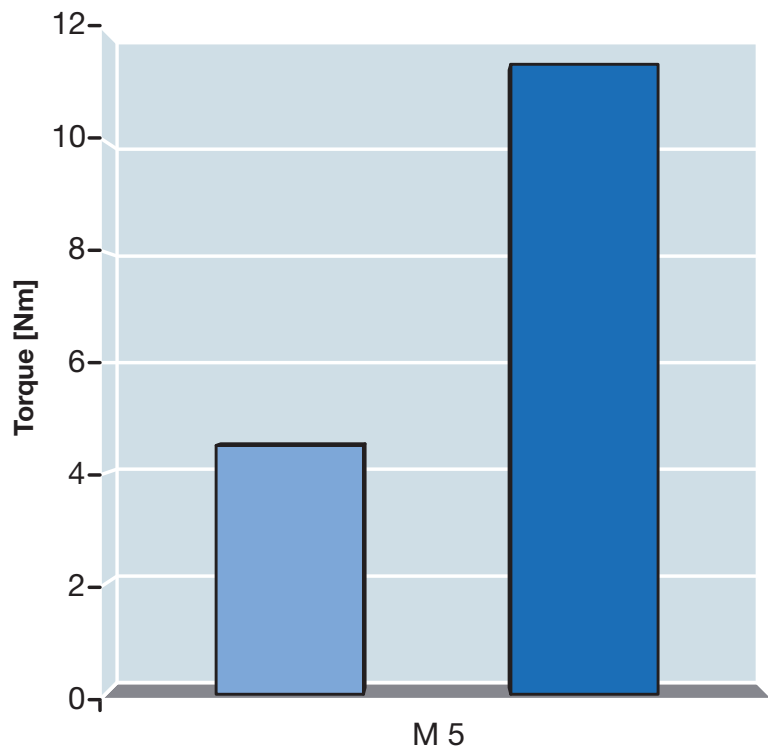

	M 5
PP ME [Nm]	4.5
PA 6 GF 30 ME [Nm]	11.4

Installation method thermal installation

Installation method self-tapping insertion

Installation method expansion anchoring

The versions – thread inserts for self-tapping insertion **QUICKSERT® plus**

Technical data

Pull-out values QUICKSERT® plus M 5

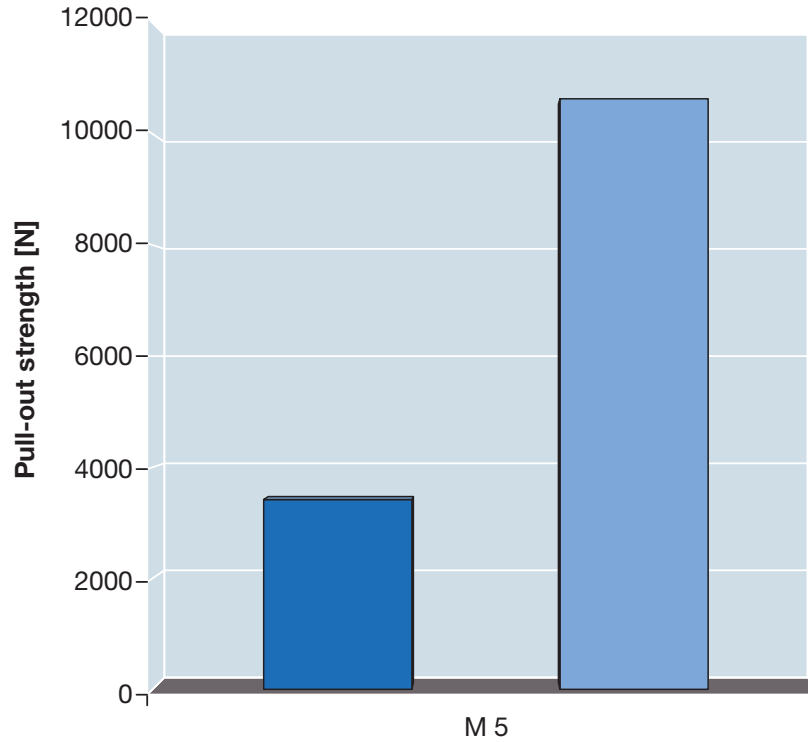

	M 5
■ PP FA [N]	3,417
■ PA 6 GF FA [N]	10,631

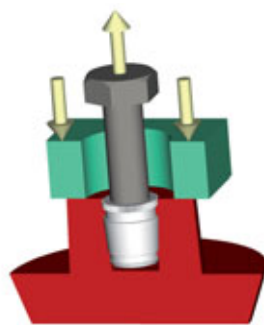

Pull-out strength (FA[N])

Technical notes

Indicated values are guide values. We recommend an installation test for the respective application. To be on the safe side, for fibre-reinforced plastics, the strengths of the non-reinforced material should be assumed. If you use brass thread inserts in plastics susceptible to stress cracks (e.g. polycarbonate), we recommend additional surface treatment of the thread inserts (nickel plating or surface coating as required). Strength values for other thread inserts on request.